

PLATINUM

735 SQM [Lobby + Hall A & B]

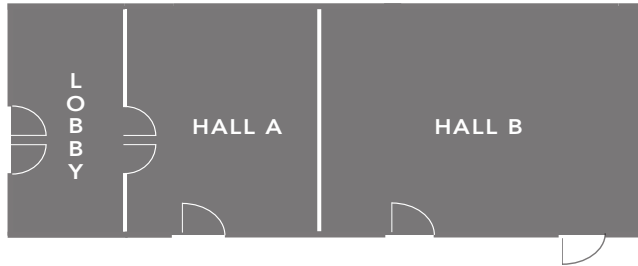

INCLUSIONS:

- House Lights
- Electricity – 100 amperes
(client to provide silent generator for additional electrical load)
- Wi-Fi – 10 Mbps
(client to upgrade bandwidth for additional Mbps requirements)
- 5 hours allotted free for Event Proper
(with air conditioning)
- 8 hours allotted free for Ingress
(without air conditioning)
- 5 hours allotted free for Egress
(without air conditioning)
- 5 hours allotted free for two (2) Dressing Rooms
(with air conditioning)
- 5 hours allotted free for Lounge Area
(with air conditioning)
- 2 Security Guards
- 3 Utilities & Restroom Attendants for Male & Female
- Restroom Amenities
- Standby Electrician
- Standby Generator
- Parking – maximum of 20 slots at Whitespace
- Caterer's Galley

PAYMENT TERMS

Security Deposit/Reservation Fee = P20,000.00

(Refundable ten (10) days after the event)

Please make a separate check payable to: WHITESPACE, INC.

Deposit for Non-Accredited Caterers = P10,000.00

(Refundable ten (10) days after the event)

Please make a separate check payable to: WHITESPACE, INC.

BOOKING POLICY:

Bookings are taken on a first come first serve basis, pending settlement of Security Deposit. Whitespace reserves the right to offer the date to another party if Security Deposit is not made within three (3) days from the date of inquiry. Bookings for events are accommodated from Mondays thru Sundays, subject to availability. In the event of back-to-back bookings, no extension hours for ingress and event proper will be entertained.

For further details, please contact our office at +632 88454917 / +632 79493673 / +63917 8215624 / +63908 8829750 and/or at info@whitespacemanila.com. Look for our Accounts Officers, Katrina Tan and/or Chanel Alfonso.

**Prices are subject to change without prior notice.*

Seated – 450 pax maximum

Cocktail – 600 pax maximum

Theatre – 700 pax maximum

Venue Fee = P175,000.00

OTHER FEES / CHARGES:

- Event Proper = P 6,500.00 / hour
(In excess of the 5 hours allotted free)
- Ingress/Egress = P 1,000.00 / hour
(In excess of the 13 hours combined allotted free)
- Dressing Room (M/F) = P 500.00 / hour
(Rental rate is per room)
- Lounge Area = P 500.00 / hour
- Additional Personnel: Utilities & Restroom Attendants or Security Guards = P 1,000.00 / head / 5 hours
- Basic Lights and Sounds = P 12,000.00
(Can accommodate acoustic duo to sextet string musicians)
- Genset Rental (150 KVA) = P 25,000.00
(With 8 hours fuel, subject to availability)
- Additional Parking on Weekends or Weekdays after 6 PM:
Ecoplaza = P 12,800.00 or MJ Plaza = P 9, 600.00
(Reserved 80 slots for 5 hours)
- Valet Service on Weekends or Weekdays after 6PM = P 15,000.00
(Inclusive of 6 valet drivers for 5 hours)
- Additional WiFi: Trunet Broadband Service

Custom Wi-Fi SSID, Unlimited Access, Responsive Support, Dynamic IP, 1-5 Days Bandwidth

- * Upgrade to 20 Mbps Trunet Broadband Service = P 23,000.00 / 1-5 Days
- * Upgrade to 30 Mbps Trunet Broadband Service = P 26,000.00 / 1-5 Days
- * Upgrade to 40 Mbps Trunet Broadband Service = P 29,000. 00 / 1-5 Days
- * Upgrade to 50 Mbps Trunet Broadband Service = P 31,000.00 / 1-5 Days
- * Upgrade to 100 Mbps Trunet Broadband Service = P 52,000.00 / 1-5 Days
- * Add-On: 5-Port Gigabit Ethernet Port for LAN access
with 2x3m ethernet cables = P 3,500.00

PAYMENT SCHEME:

- Security Deposit: Upon reservation
(Refundable amount ten (10) days after the event)
- Venue Fee Down Payment (50%)
Upon reservation or at least 45 days prior to the event
- Venue Fee Balance (50%): No later than 30 days prior to the event
- Please make a separate check payable to: WHITESPACE, INC.
- Venue fee is inclusive of all applicable taxes